

## Molding Type Module IGBT, 2-in-1 Package, 1200 V and 300 A



Double INT-A-PAK

### FEATURES

- 10  $\mu$ s short circuit capability
- $V_{CE(on)}$  with positive temperature coefficient
- Maximum junction temperature 150 °C
- Low inductance case
- Fast and soft reverse recovery antiparallel FWD
- Isolated copper baseplate using DCB (Direct Copper Bonding) technology
- Material categorization: for definitions of compliance please see [www.vishay.com/doc?99912](http://www.vishay.com/doc?99912)

**RoHS**  
COMPLIANT

PRODUCT SUMMARY	
$V_{CES}$	1200 V
$I_C$ at $T_C = 80\text{ °C}$	300 A
$V_{CE(on)}$ (typical) at $I_C = 300\text{ A}$ , $25\text{ °C}$	2.00 V
Speed	8 kHz to 30 kHz
Package	Double INT-A-PAK
Circuit	Half bridge

### TYPICAL APPLICATIONS

- UPS
- Inverter for motor drive
- AC and DC servo drive amplifier

### DESCRIPTION

Vishay's IGBT power module provides ultra low conduction loss as well as short circuit ruggedness. It is designed for applications such as general inverters and UPS.

ABSOLUTE MAXIMUM RATINGS ( $T_C = 25\text{ °C}$ unless otherwise noted)				
PARAMETER	SYMBOL	TEST CONDITIONS	MAX.	UNITS
Collector to emitter voltage	$V_{CES}$		1200	V
Gate to emitter voltage	$V_{GES}$		$\pm 20$	
Collector current	$I_C$	$T_C = 25\text{ °C}$	500	A
		$T_C = 80\text{ °C}$	300	
Pulsed collector current	$I_{CM}^{(1)}$	$t_p = 1\text{ ms}$	600	
Diode continuous forward current	$I_F$	$T_C = 80\text{ °C}$	300	
Diode maximum forward current	$I_{FM}$	$t_p = 1\text{ ms}$	600	
Maximum power dissipation	$P_D$	$T_J = 150\text{ °C}$	1645	
Short circuit withstand time	$t_{SC}$	$T_J = 125\text{ °C}$	10	$\mu$ s
RMS isolation voltage	$V_{ISOL}$	$f = 50\text{ Hz}$ , $t = 1\text{ min}$	2500	V

#### Note

<sup>(1)</sup> Repetitive rating; pulse width limited by maximum junction temperature.



IGBT ELECTRICAL SPECIFICATIONS (T <sub>C</sub> = 25 °C unless otherwise noted)						
PARAMETER	SYMBOL	TEST CONDITIONS	MIN.	TYP.	MAX.	UNITS
Collector to emitter breakdown voltage	V <sub>(BR)CES</sub>	T <sub>J</sub> = 25 °C	1200	-	-	V
Collector to emitter voltage	V <sub>CE(on)</sub>	V <sub>GE</sub> = 15 V, I <sub>C</sub> = 300 A, T <sub>J</sub> = 25 °C	-	2.00	2.45	
		V <sub>GE</sub> = 15 V, I <sub>C</sub> = 300 A, T <sub>J</sub> = 125 °C	-	2.20	-	
Gate to emitter threshold voltage	V <sub>GE(th)</sub>	V <sub>CE</sub> = V <sub>GE</sub> , I <sub>C</sub> = 12 mA, T <sub>J</sub> = 25 °C	5.0	6.2	7.0	
Collector cut-off current	I <sub>CES</sub>	V <sub>CE</sub> = V <sub>CES</sub> , V <sub>GE</sub> = 0 V, T <sub>J</sub> = 25 °C	-	-	5.0	mA
Gate to emitter leakage current	I <sub>GES</sub>	V <sub>GE</sub> = V <sub>GES</sub> , V <sub>CE</sub> = 0 V, T <sub>J</sub> = 25 °C	-	-	400	nA

SWITCHING CHARACTERISTICS						
PARAMETER	SYMBOL	TEST CONDITIONS	MIN.	TYP.	MAX.	UNITS
Turn-on delay time	t <sub>d(on)</sub>	V <sub>CC</sub> = 600 V, I <sub>C</sub> = 300 A, R <sub>g</sub> = 4.7 Ω, V <sub>GE</sub> = ± 15 V, T <sub>J</sub> = 25 °C	-	574	-	ns
Rise time	t <sub>r</sub>		-	133	-	
Turn-off delay time	t <sub>d(off)</sub>		-	563	-	
Fall time	t <sub>f</sub>		-	120	-	
Turn-on switching loss	E <sub>on</sub>	V <sub>CC</sub> = 600 V, I <sub>C</sub> = 300 A, R <sub>g</sub> = 4.7 Ω, V <sub>GE</sub> = ± 15 V, T <sub>J</sub> = 125 °C	-	23.9	-	mJ
Turn-off switching loss	E <sub>off</sub>		-	25.3	-	
Turn-on delay time	t <sub>d(on)</sub>		-	604	-	
Rise time	t <sub>r</sub>		-	137	-	
Turn-off delay time	t <sub>d(off)</sub>	V <sub>CC</sub> = 600 V, I <sub>C</sub> = 300 A, R <sub>g</sub> = 4.7 Ω, V <sub>GE</sub> = ± 15 V, T <sub>J</sub> = 125 °C	-	629	-	ns
Fall time	t <sub>f</sub>		-	167	-	
Turn-on switching loss	E <sub>on</sub>		-	31.5	-	
Turn-off switching loss	E <sub>off</sub>		-	35.9	-	
Input capacitance	C <sub>ies</sub>	V <sub>GE</sub> = 0 V, V <sub>CE</sub> = 25 V, f = 1.0 MHz	-	21.2	-	nF
Output capacitance	C <sub>oes</sub>		-	1.42	-	
Reverse transfer capacitance	C <sub>res</sub>		-	0.94	-	
SC data	I <sub>SC</sub>	t <sub>sc</sub> ≤ 10 μs, V <sub>GE</sub> = 15 V, T <sub>J</sub> = 125 °C, V <sub>CC</sub> = 900 V, V <sub>CEM</sub> ≤ 1200 V	-	1800	-	A
Internal gate resistance	R <sub>gint</sub>		-	1.0	-	Ω
Stray inductance	L <sub>CE</sub>		-	-	20	nH
Module lead resistance, terminal to chip	R <sub>CC'+EE'</sub>	T <sub>C</sub> = 25 °C	-	0.35	-	mΩ

DIODE ELECTRICAL SPECIFICATIONS (T <sub>C</sub> = 25 °C unless otherwise noted)							
PARAMETER	SYMBOL	TEST CONDITIONS	MIN.	TYP.	MAX.	UNITS	
Diode forward voltage	V <sub>F</sub>	I <sub>F</sub> = 300 A	T <sub>J</sub> = 25 °C	-	1.82	2.25	V
			T <sub>J</sub> = 125 °C	-	1.95	-	
Diode reverse recovery charge	Q <sub>rr</sub>	I <sub>F</sub> = 300 A, V <sub>R</sub> = 600 V, di/dt = -2360 A/μs, V <sub>GE</sub> = -15 V	T <sub>J</sub> = 25 °C	-	20.2	-	μC
			T <sub>J</sub> = 125 °C	-	40.1	-	
Diode peak reverse recovery current	I <sub>rr</sub>	I <sub>F</sub> = 300 A, V <sub>R</sub> = 600 V, di/dt = -2360 A/μs, V <sub>GE</sub> = -15 V	T <sub>J</sub> = 25 °C	-	170	-	A
			T <sub>J</sub> = 125 °C	-	250	-	
Diode reverse recovery energy	E <sub>rec</sub>	I <sub>F</sub> = 300 A, V <sub>R</sub> = 600 V, di/dt = -2360 A/μs, V <sub>GE</sub> = -15 V	T <sub>J</sub> = 25 °C	-	8.2	-	mJ
			T <sub>J</sub> = 125 °C	-	21.7	-	



THERMAL AND MECHANICAL SPECIFICATIONS						
PARAMETER	SYMBOL	TEST CONDITIONS	MIN.	TYP.	MAX.	UNITS
Operating junction temperature range	$T_J$		-	-	150	°C
Storage temperature range	$T_{STG}$		-40	-	125	
Junction to case	IGBT	$R_{thJC}$	-	-	0.076	K/W
	Diode		-	-	0.100	
Case to sink	$R_{thCS}$	Conductive grease applied	-	0.035	-	
Mounting torque		Power terminal screw: M6	2.5 to 5.0			Nm
		Mounting screw: M6	3.0 to 5.0			
Weight			300			g

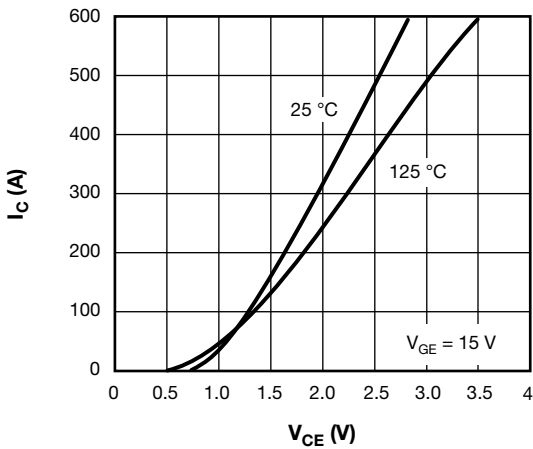

Fig. 1 - IGBT Typical Output Characteristics

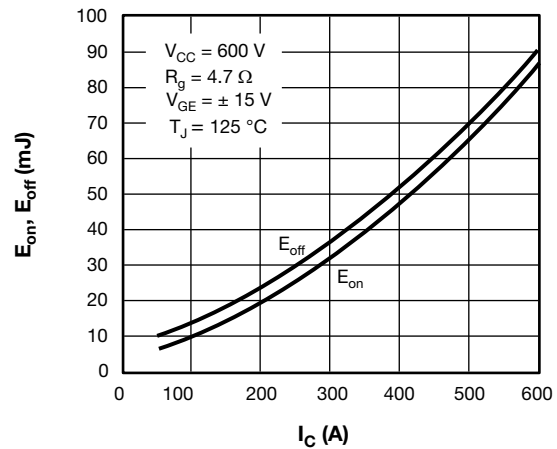

Fig. 3 - IGBT Switching Loss vs.  $I_C$

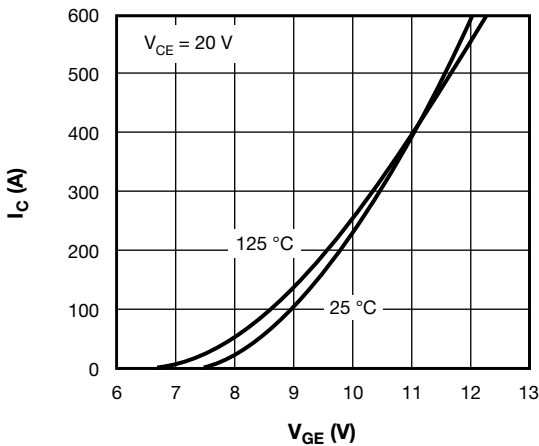

Fig. 2 - IGBT Typical Transfer Characteristics

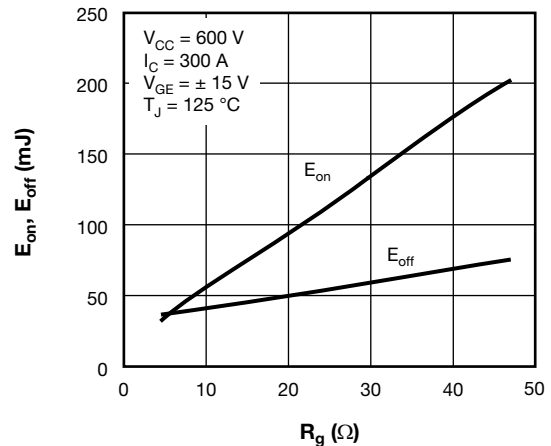
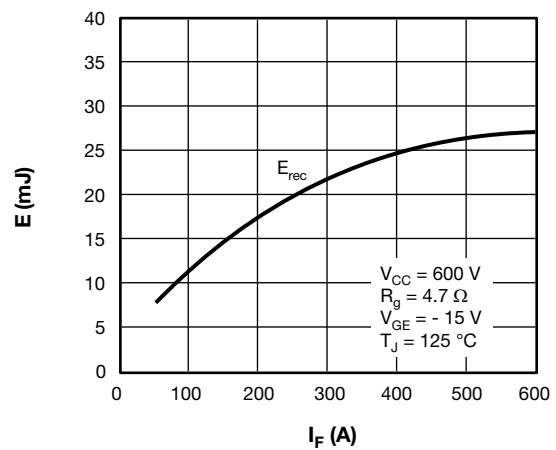
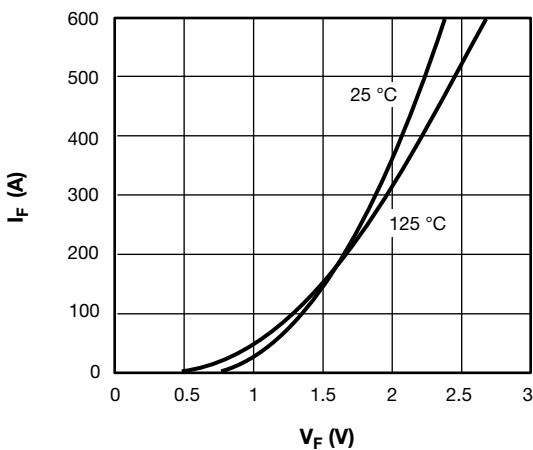
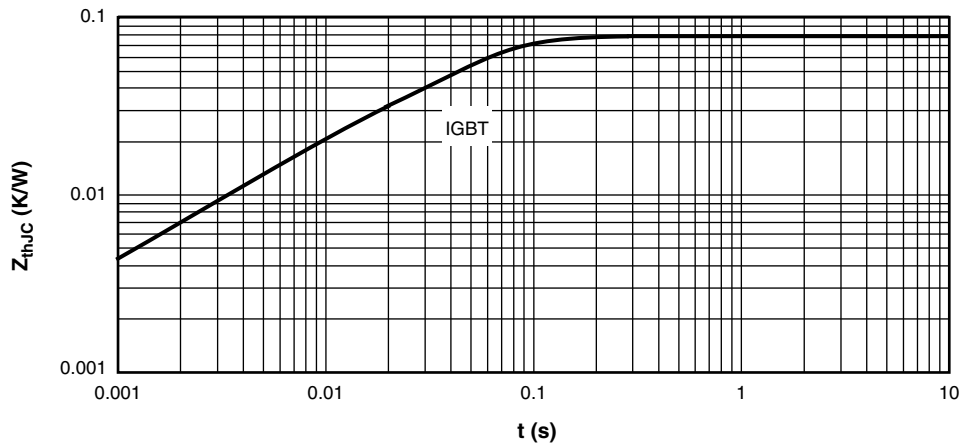
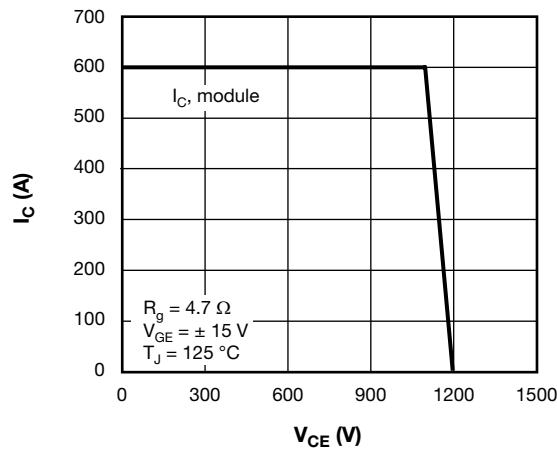

Fig. 4 - IGBT Switching Loss vs.  $R_g$



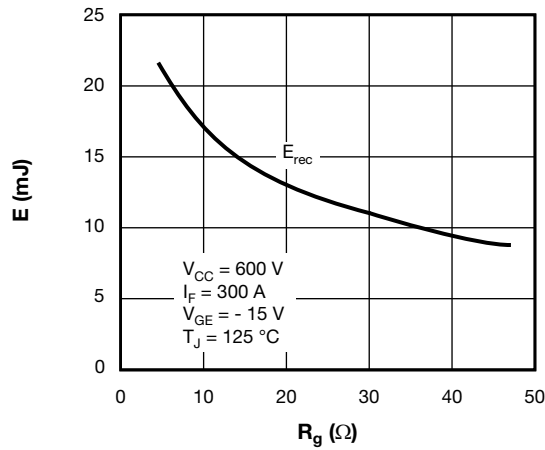

Fig. 9 - Diode Switching Loss vs. Gate Resistance  $R_g$

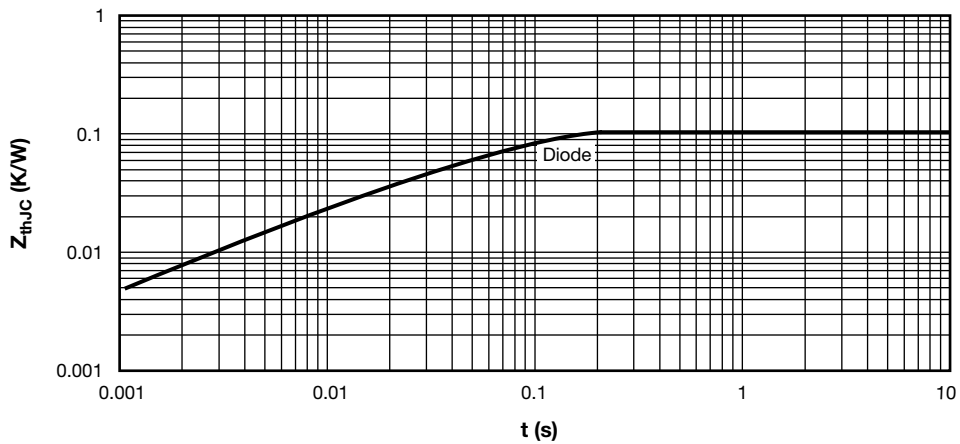
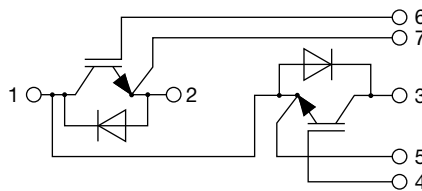

Fig. 10 - Diode Transient Thermal Impedance

**CIRCUIT CONFIGURATION**



LINKS TO RELATED DOCUMENTS	
Dimensions	<a href="http://www.vishay.com/doc?95525">www.vishay.com/doc?95525</a>

## Double INT-A-PAK

**DIMENSIONS** in millimeters (inches)

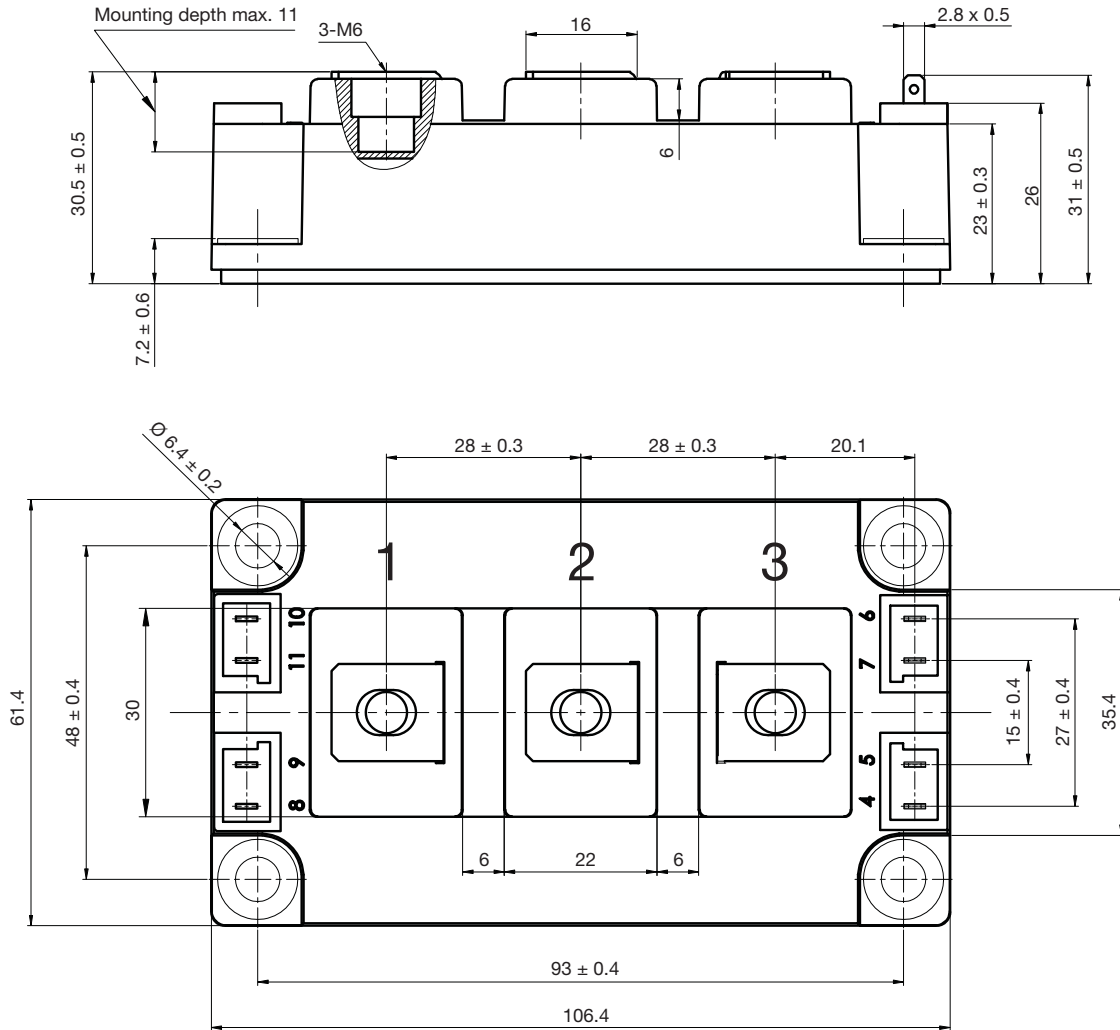



## **Disclaimer**

ALL PRODUCT, PRODUCT SPECIFICATIONS AND DATA ARE SUBJECT TO CHANGE WITHOUT NOTICE TO IMPROVE RELIABILITY, FUNCTION OR DESIGN OR OTHERWISE.

Vishay Intertechnology, Inc., its affiliates, agents, and employees, and all persons acting on its or their behalf (collectively, "Vishay"), disclaim any and all liability for any errors, inaccuracies or incompleteness contained in any datasheet or in any other disclosure relating to any product.

Vishay makes no warranty, representation or guarantee regarding the suitability of the products for any particular purpose or the continuing production of any product. To the maximum extent permitted by applicable law, Vishay disclaims (i) any and all liability arising out of the application or use of any product, (ii) any and all liability, including without limitation special, consequential or incidental damages, and (iii) any and all implied warranties, including warranties of fitness for particular purpose, non-infringement and merchantability.

Statements regarding the suitability of products for certain types of applications are based on Vishay's knowledge of typical requirements that are often placed on Vishay products in generic applications. Such statements are not binding statements about the suitability of products for a particular application. It is the customer's responsibility to validate that a particular product with the properties described in the product specification is suitable for use in a particular application. Parameters provided in datasheets and / or specifications may vary in different applications and performance may vary over time. All operating parameters, including typical parameters, must be validated for each customer application by the customer's technical experts. Product specifications do not expand or otherwise modify Vishay's terms and conditions of purchase, including but not limited to the warranty expressed therein.

Except as expressly indicated in writing, Vishay products are not designed for use in medical, life-saving, or life-sustaining applications or for any other application in which the failure of the Vishay product could result in personal injury or death. Customers using or selling Vishay products not expressly indicated for use in such applications do so at their own risk. Please contact authorized Vishay personnel to obtain written terms and conditions regarding products designed for such applications.

No license, express or implied, by estoppel or otherwise, to any intellectual property rights is granted by this document or by any conduct of Vishay. Product names and markings noted herein may be trademarks of their respective owners.